



# **Visoglide Plus Sliding Patio Door**

## Installation Guide

**Kit-form assembly**  
Sections 1-7



**Door installation**  
Sections 8-13

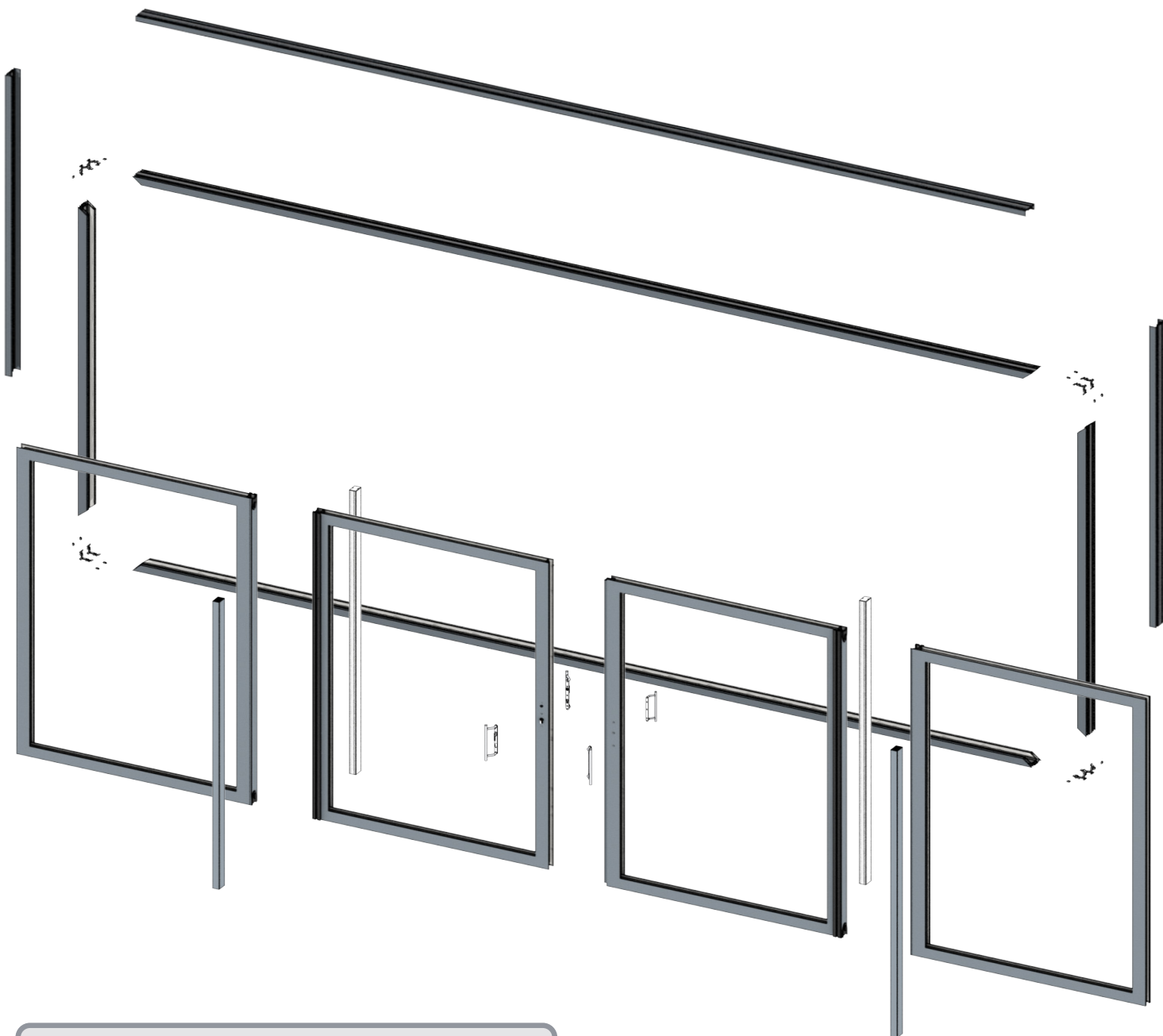

## TOOLS & CONSUMABLES



Not Supplied



Frame Packers  
Not Supplied



Frame Fixings  
Not Supplied

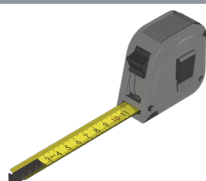

Tape Measure



Glazing Paddle

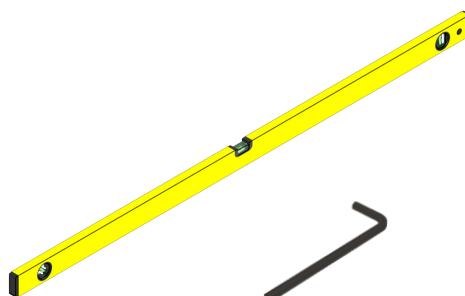

Spirit Level



2.5mm Hex Key



Cordless  
Driver / Drill

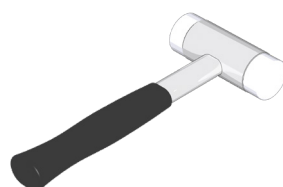

Soft Mallet

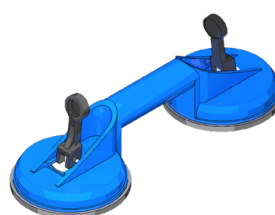

Glazing Suction Lifters



5mm Drill Bit

## KITFORM PACKAGING CONTENTS

**KF** Denotes kit-form parts only

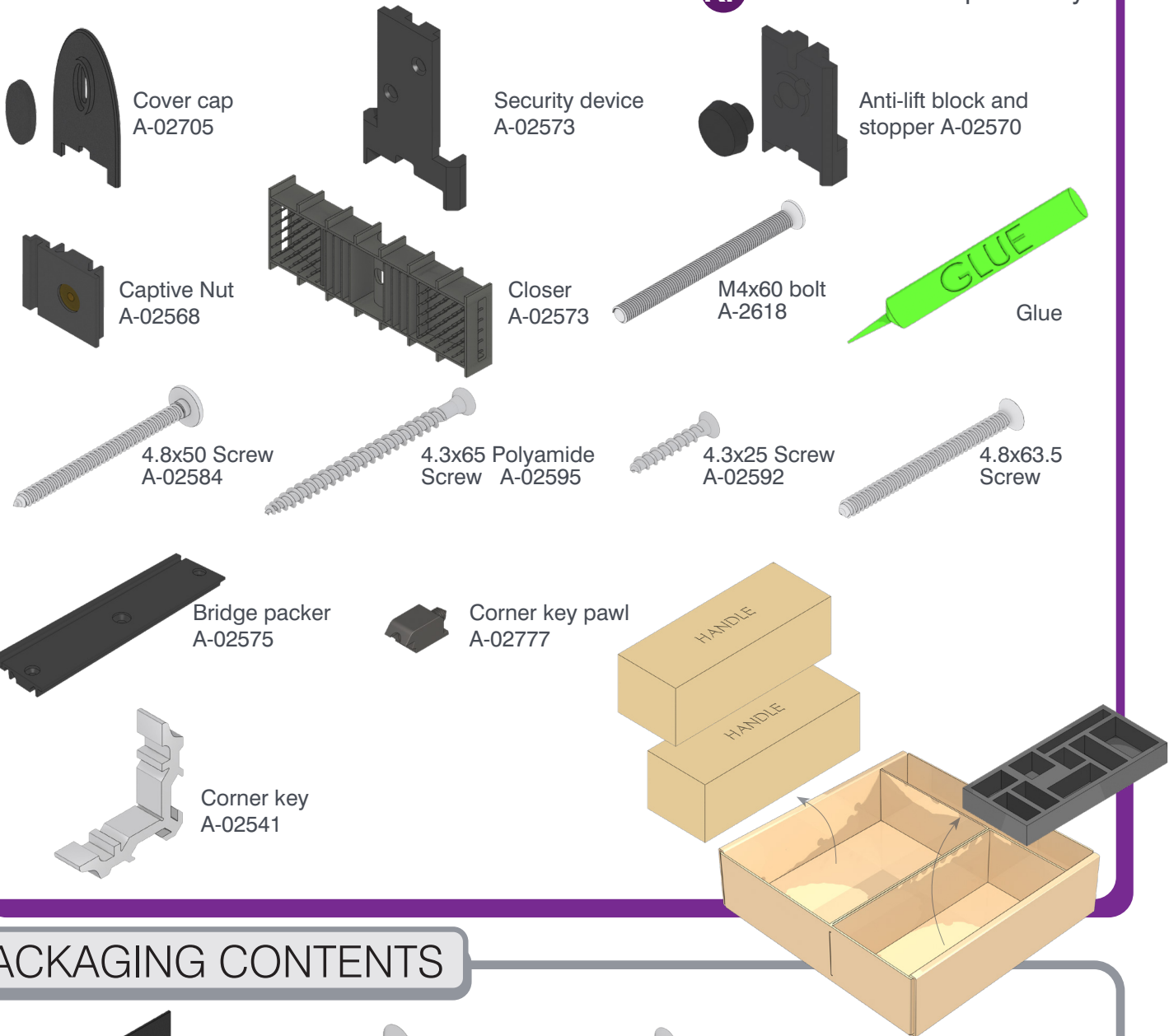

## PACKAGING CONTENTS

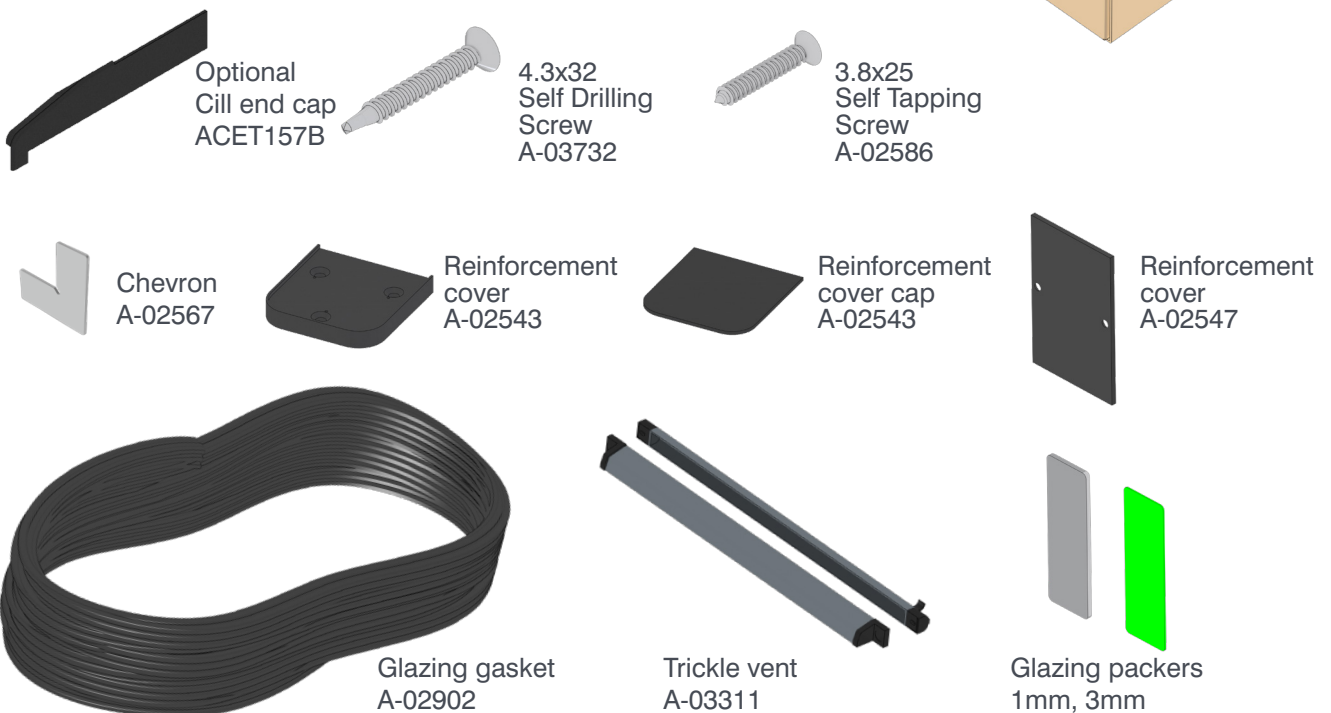

## OUTER FRAME ASSEMBLY

KF

1

A-02584 4.8x50

50mm 1:1



Not  
Supplied

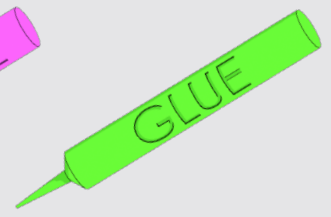

### 1 Silicone application

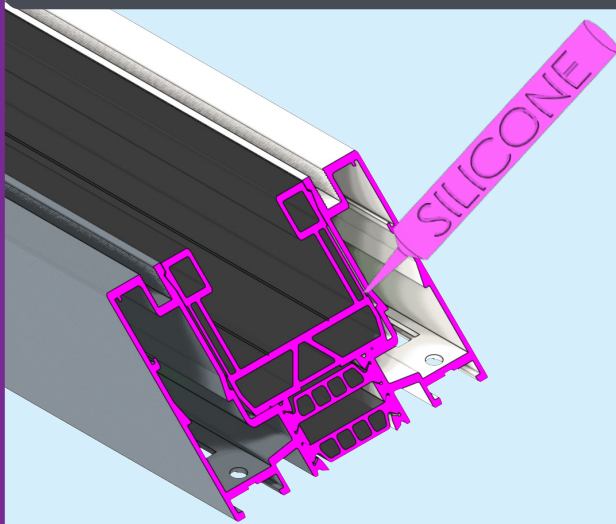

### 2 Glue application

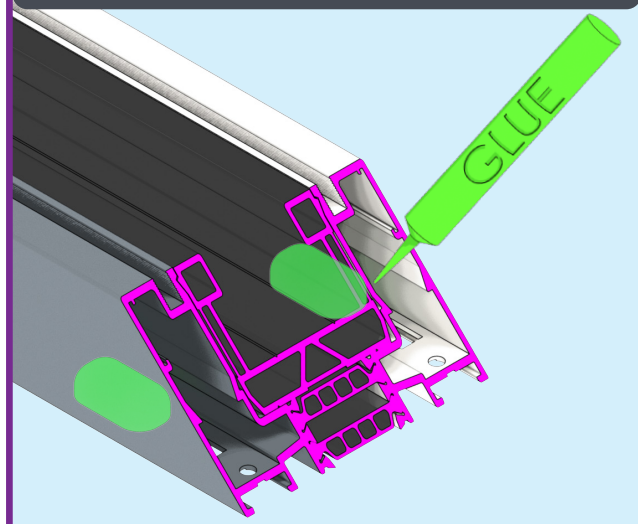

## CORNER ASSEMBLY

KF



A-02777  
x16

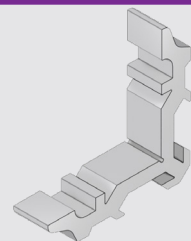

A-02541  
x8

### 3 Corner key positioning

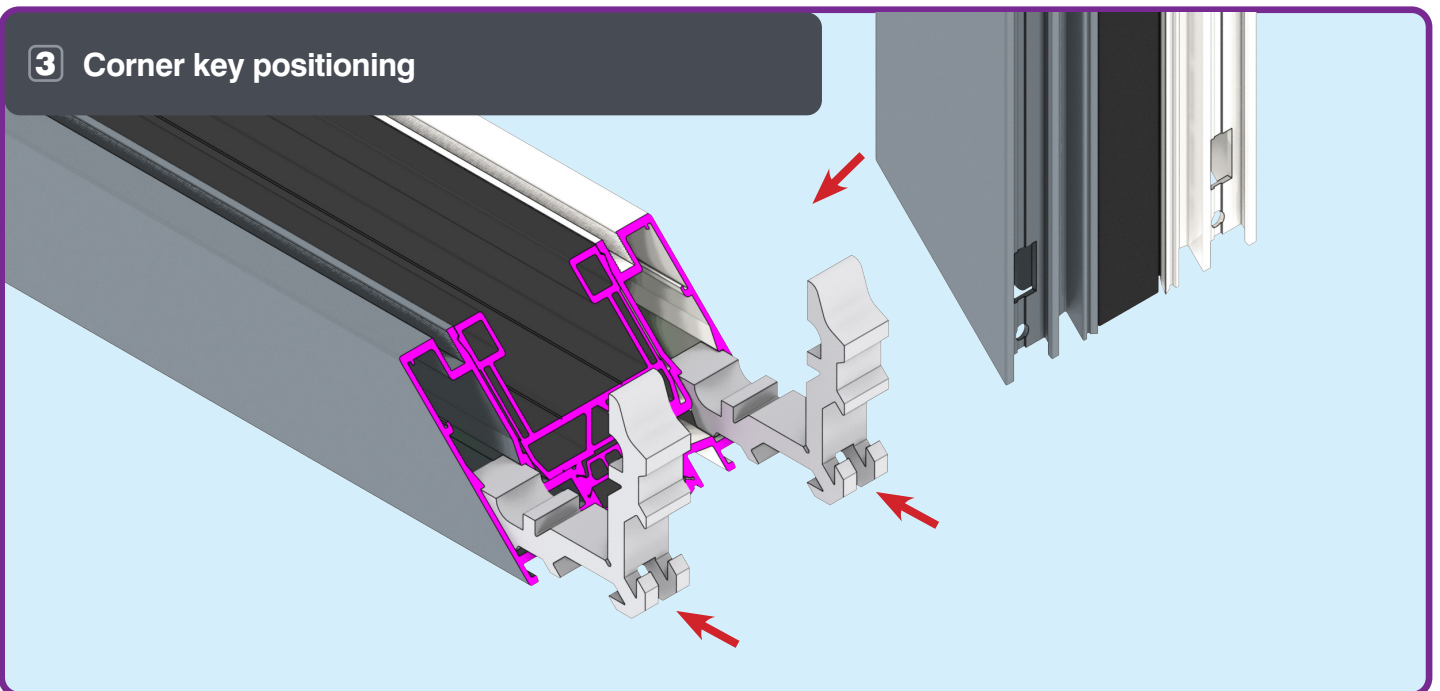



## CORNER ASSEMBLY

KF

### 2 Place corner key pawls

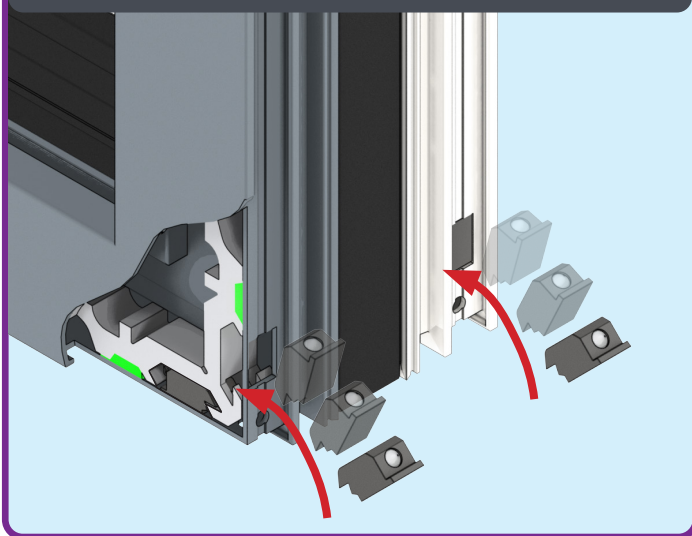

### 3 Adjust corner key pawls

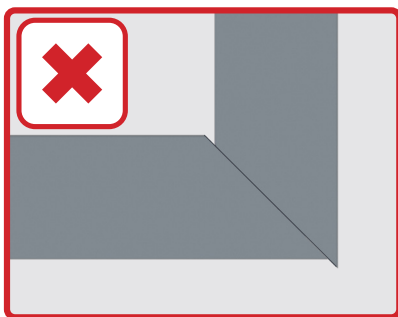
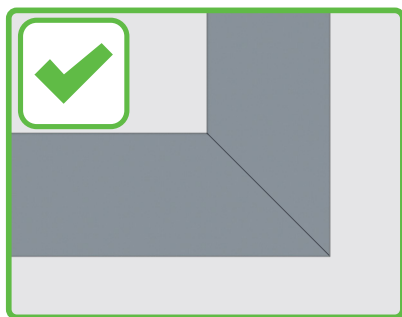
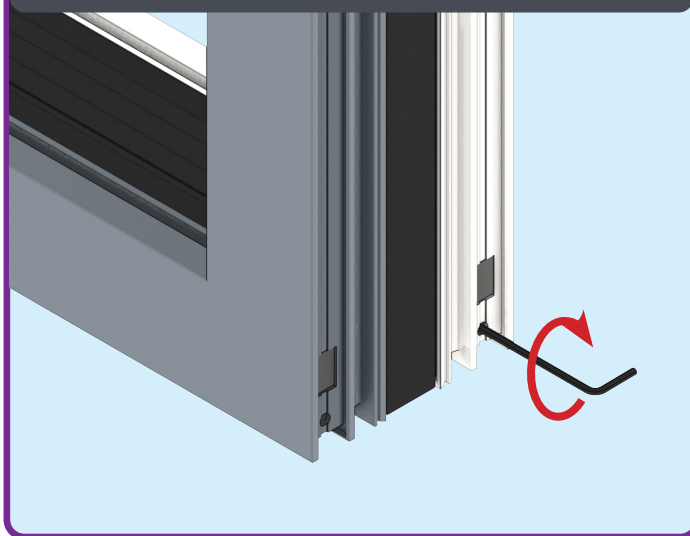

**CORNER DETAIL:**  
Ensure corners are correctly aligned and flush

## OPTIONAL - FRAME EXTENDERS

### Align holes and fix - Type A

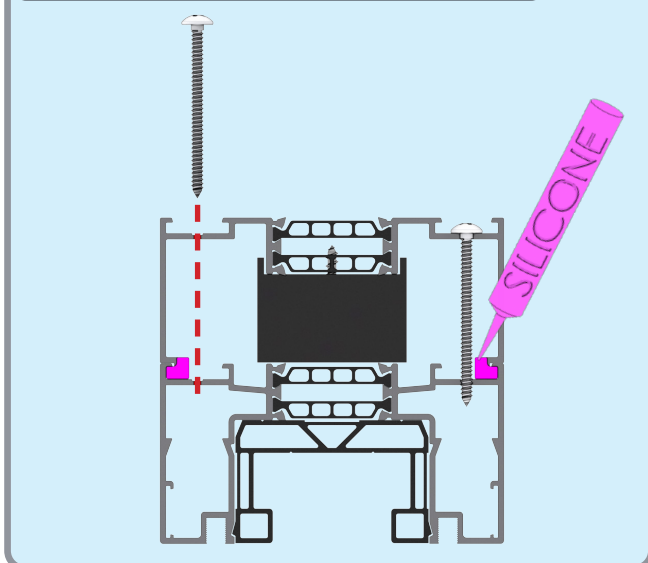

### Align holes and fix - Type B

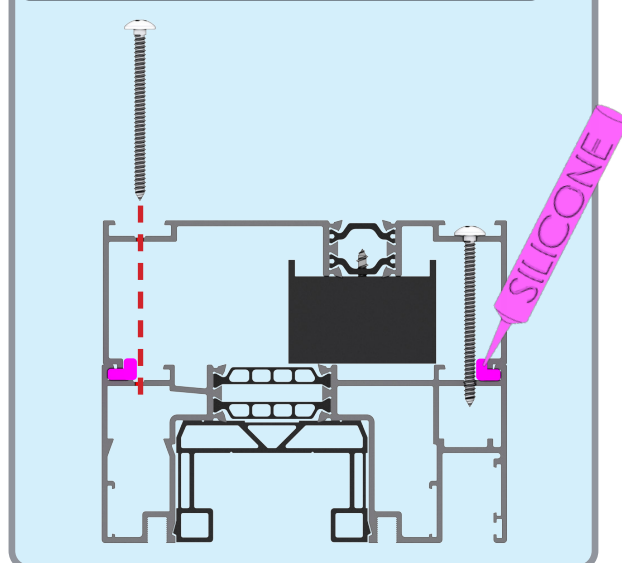

**Do not over tighten to avoid distortion**

# FIXED SASH ASSEMBLY

KF

A-02591 4.8x63.5

2

63.5mm 1:1

External View

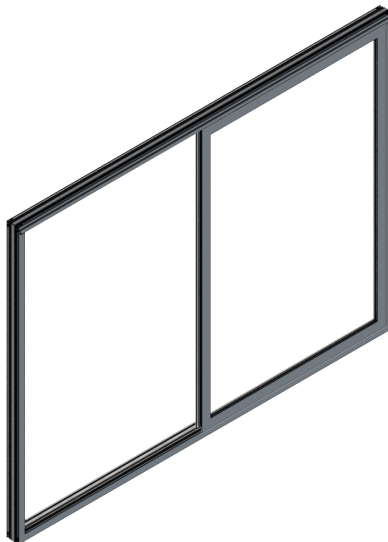

1 Tilt up into head then seat rails

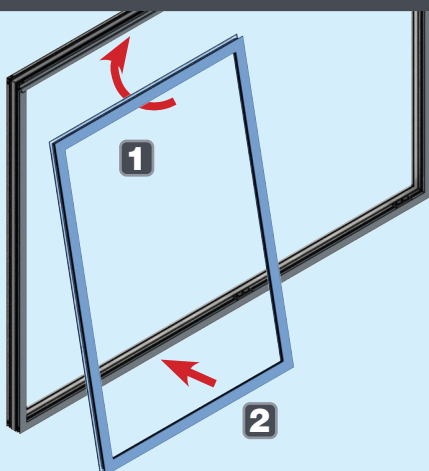

2 Slide into position

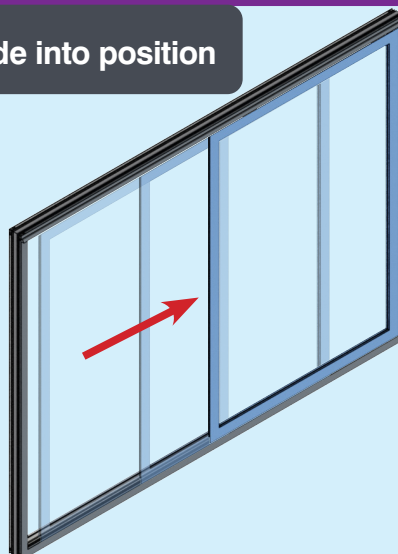

3 Secure frame through bridge packers

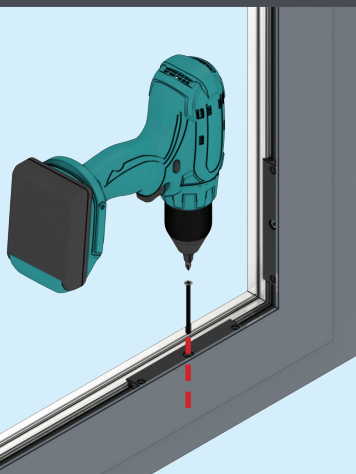

4 Detail of sash bridge packers position

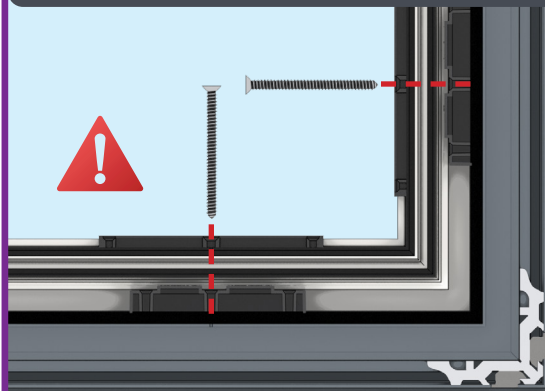

Bridge packer hole must align with the hole under sash

# SLIDING SASH ASSEMBLY

KF

3

Internal View

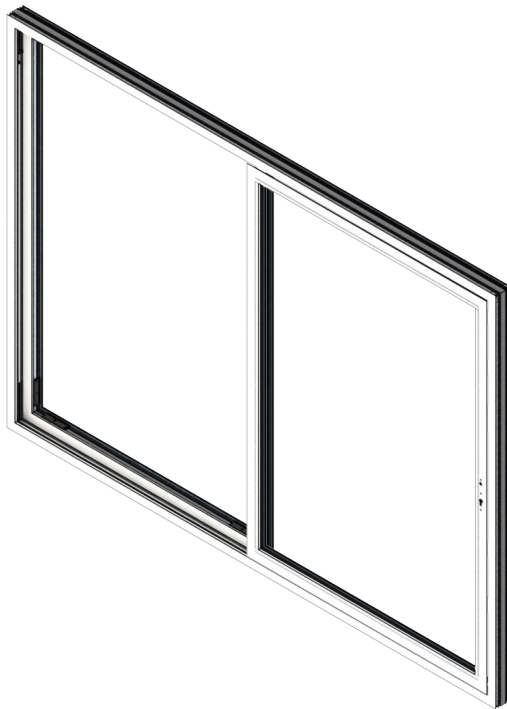

1 Tilt into head then seat rollers

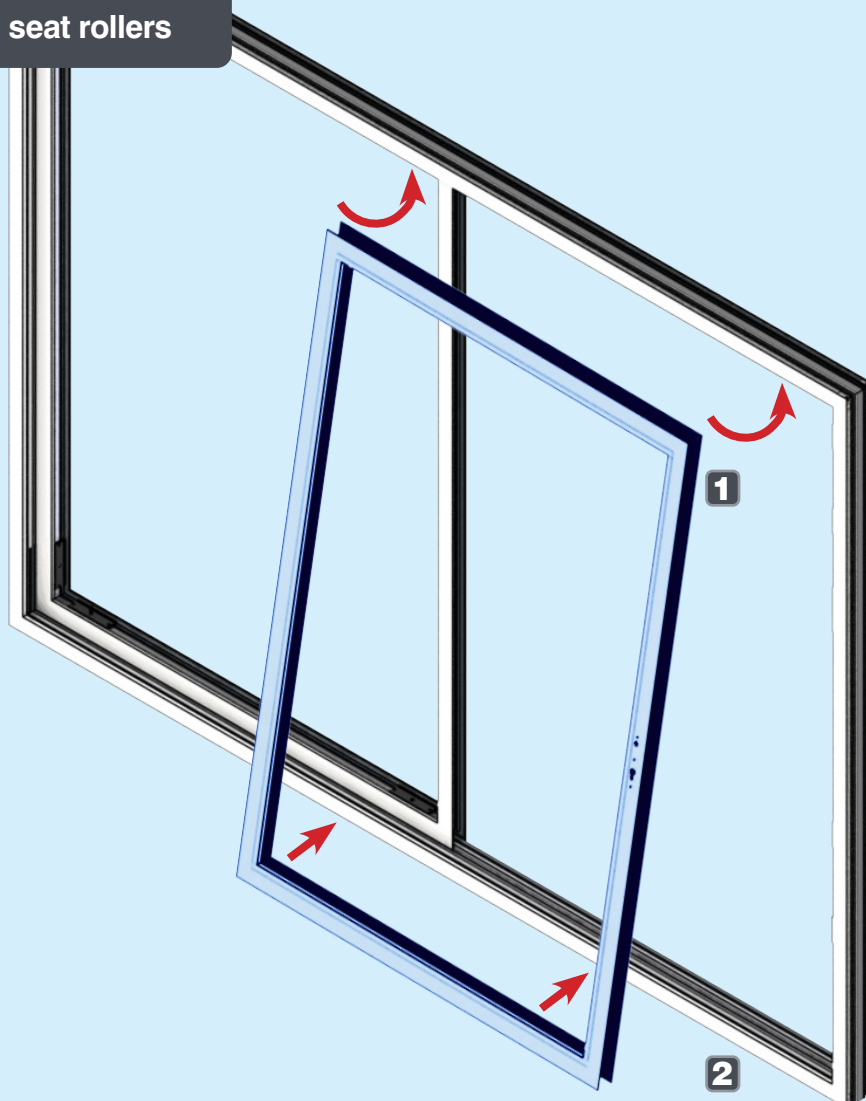

## 4

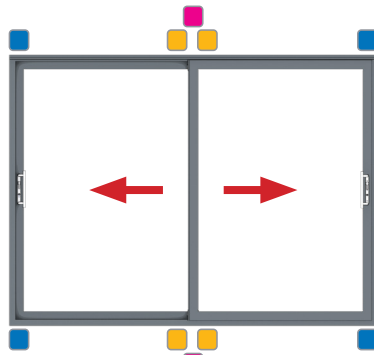

Style 21

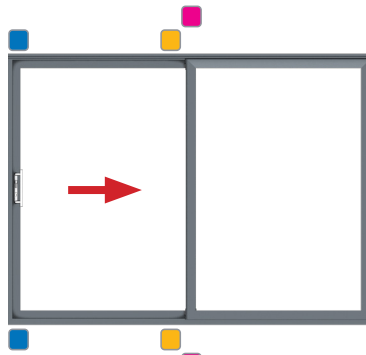

Style 22

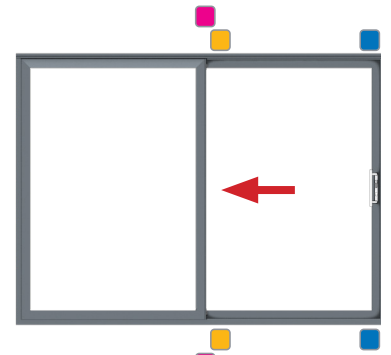

Style 23

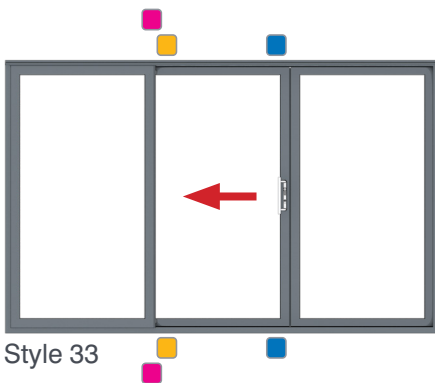

Style 33

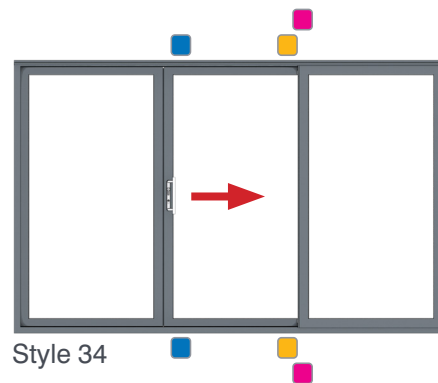

Style 34

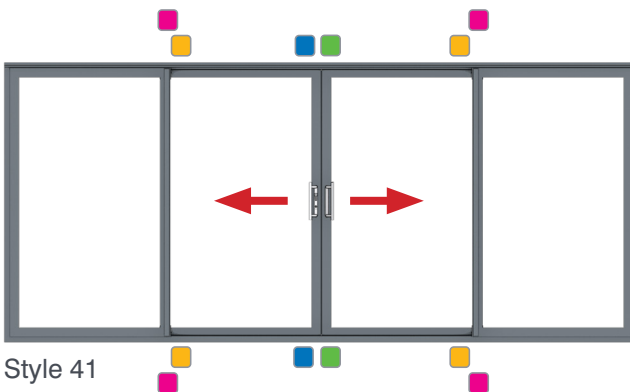

Style 41

### Device location key

- Security device
- Anti-lift device
- Anti-lift device with stopper
- Closer

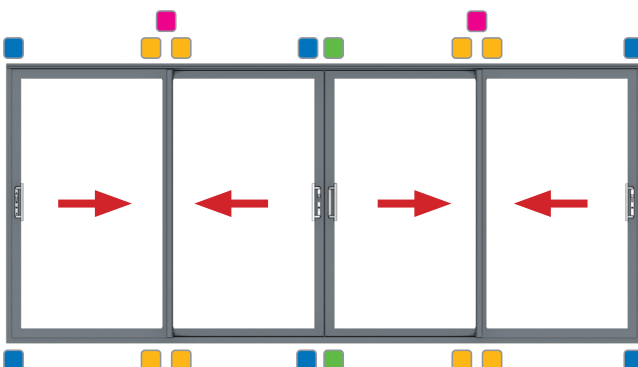

Style 42

# SECURITY CONFIGURATIONS

KF

5

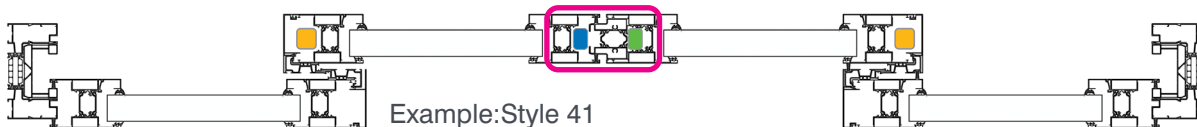

## Security device

A-02573

A-02592 - 4.3x25

25mm 1:1

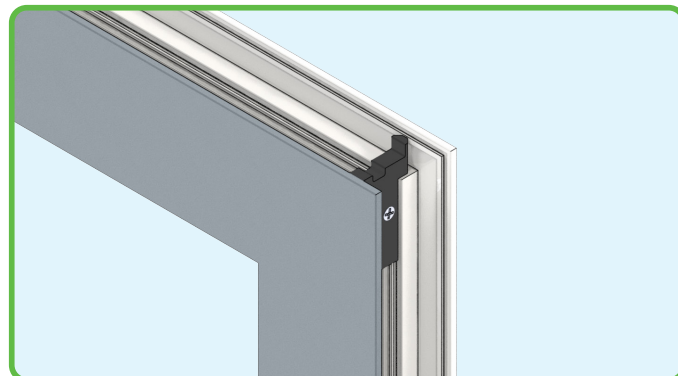

## Anti lift device

A-03311

A-02592 - 4.3x25

25mm 1:1

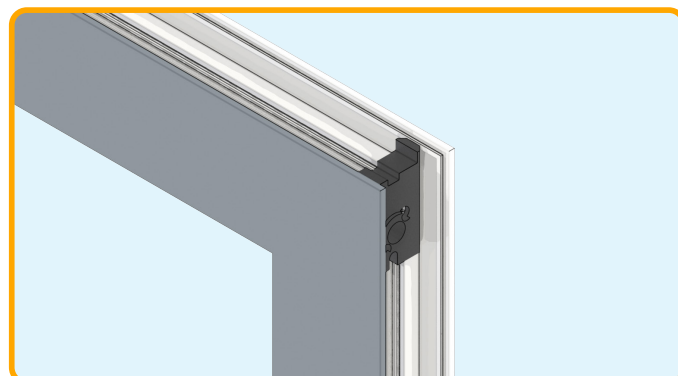

## Anti lift device with stopper

A-02570

A-02592 - 4.3x25

25mm 1:1

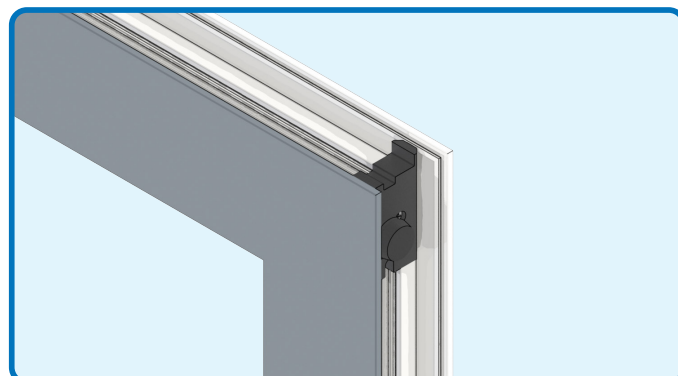

## Closer

A-02573

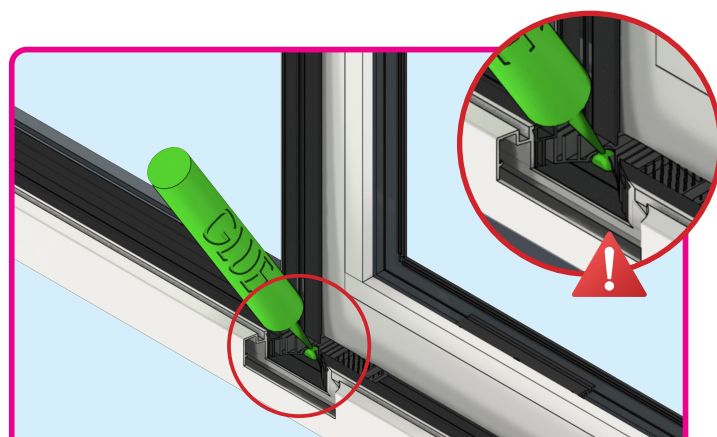

Locate centrally and apply glue to hole indicated



## INTERLOCK COVER TRIM

KF

6

4.3x65 A-02595

65mm 1:1

Cover cap  
A-02705

### 1 Cover trim installation



**Install after sash is installed in frame**

### 2 Interlock assembly

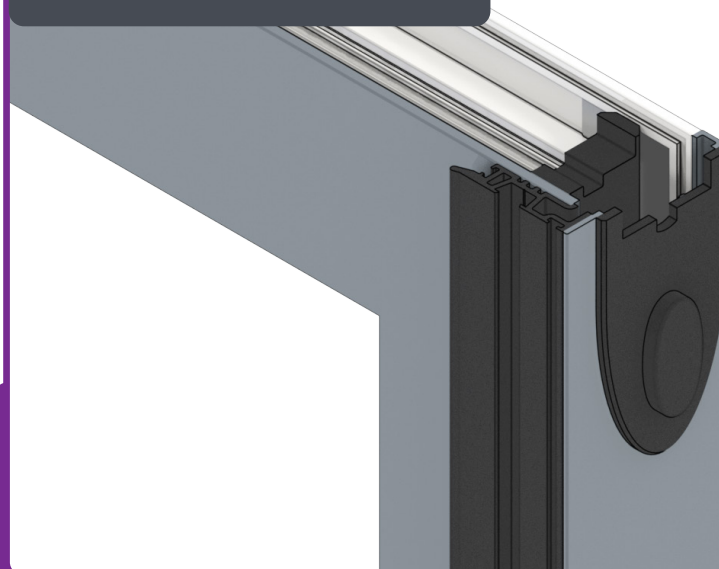

# MEETING STILE INSTALLATION

KF

7



M4x60 bolt  
A-2618

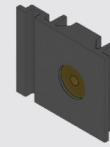

Captive Nut  
A-02568

## Section view

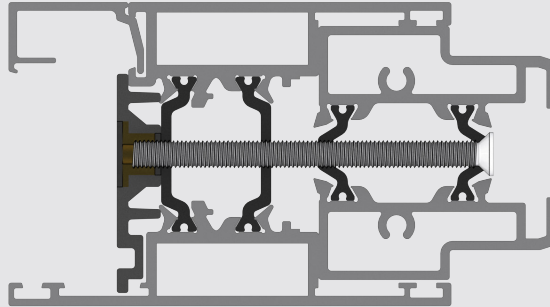

## Meeting Stile Installation

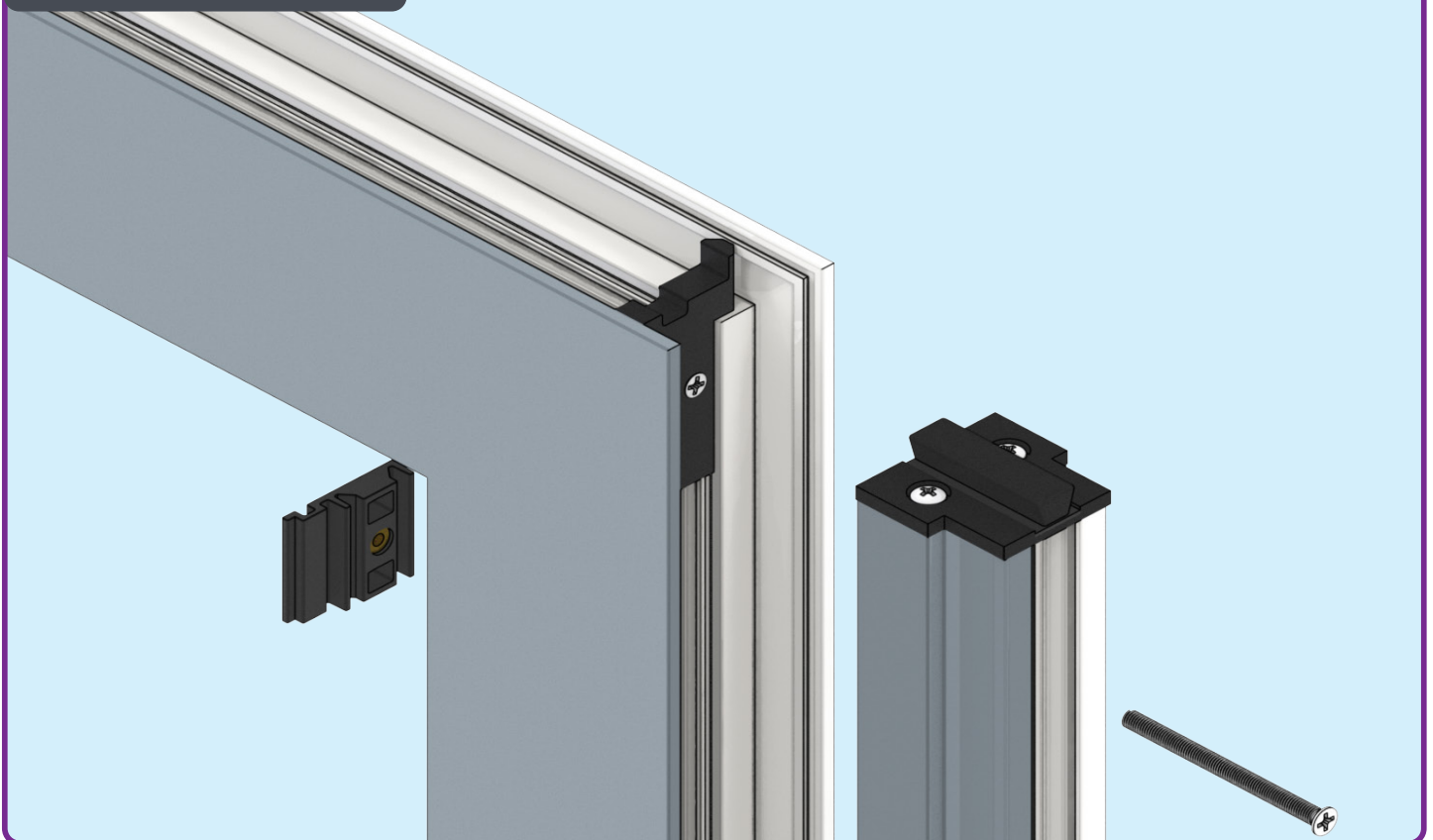

# GENERAL ASSEMBLY - NON Kit-form INSTALLATION

## INTERLOCK REINFORCEMENT INSTALLATION

8

3.8x25  
A-02585

25mm 1:1

### 1 Medium reinforcement

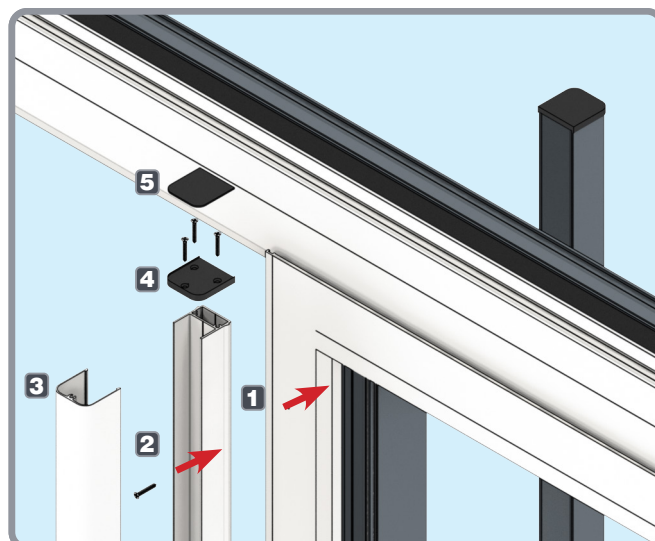
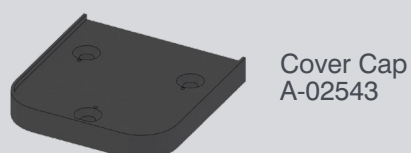
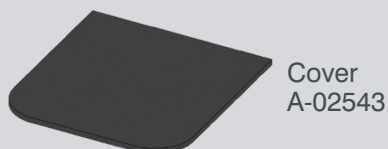

### 2 Heavy reinforcement

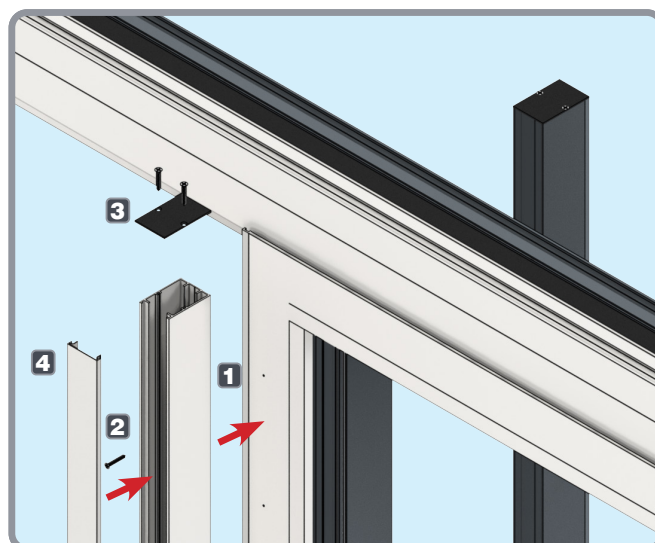

### 3 Heavy reinforcement with box section

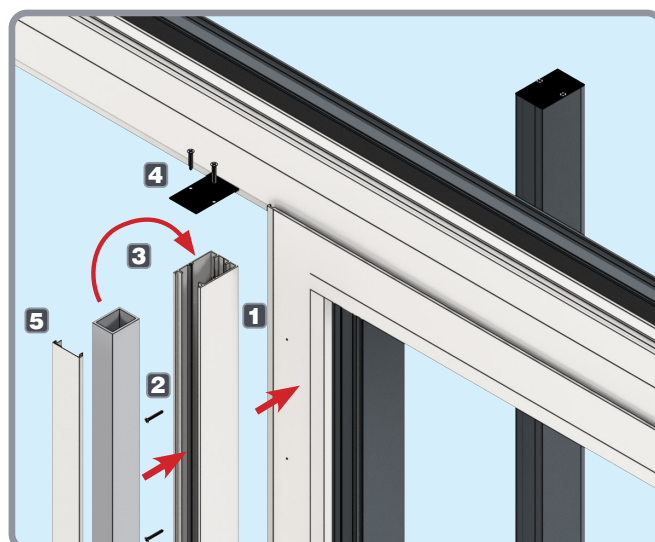
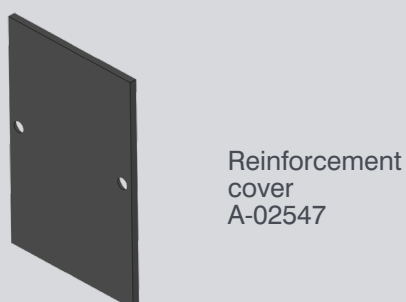

# MEETING STILE REINFORCEMENT INSTALLATION

## 4 Heavy reinforcement



Reinforcement  
cover  
A-02547

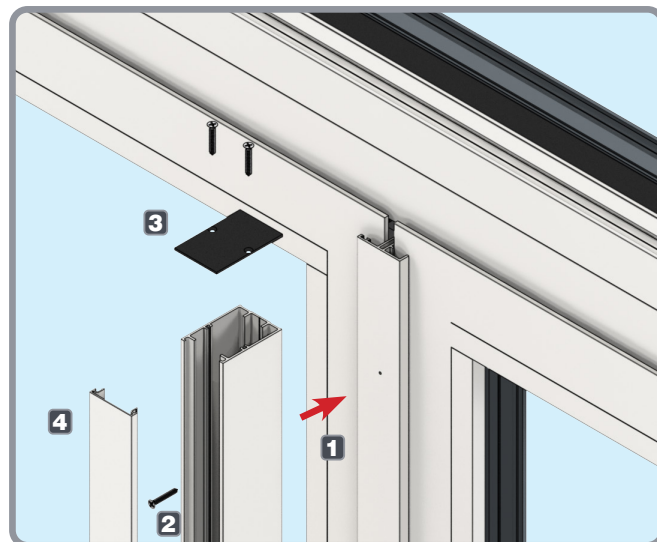

## 5 Heavy reinforcement with box section



Reinforcement  
cover  
A-02547

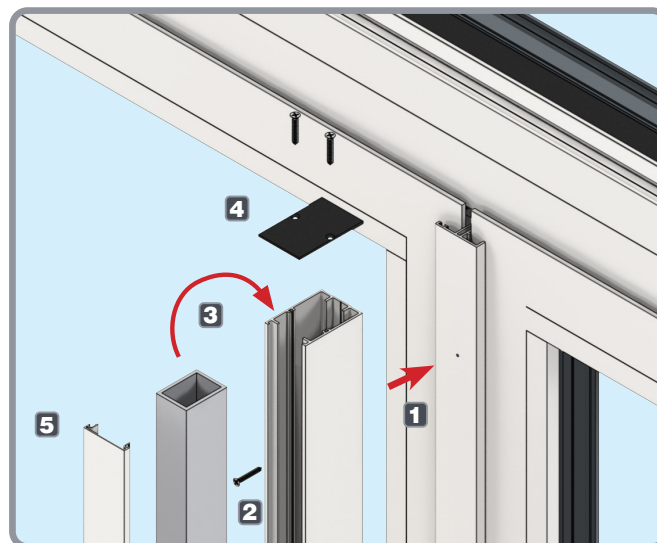

# CILL INSTALLATION

9



Not  
Supplied



Not  
Supplied



Not  
Supplied

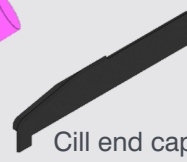

Cill end cap  
ACET157B

## 1 Silicone end cap in position

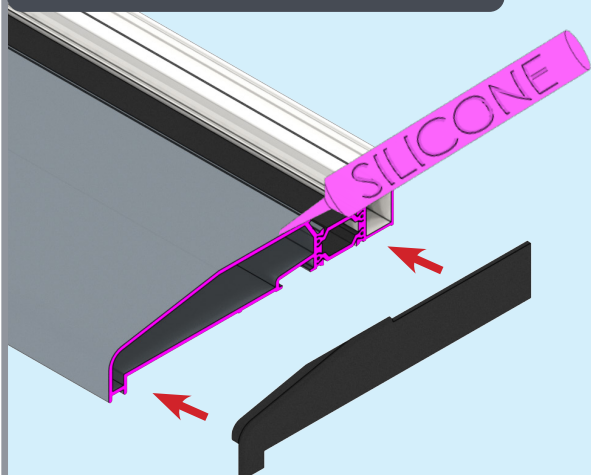

## 2 Drill cill at 400mm centres

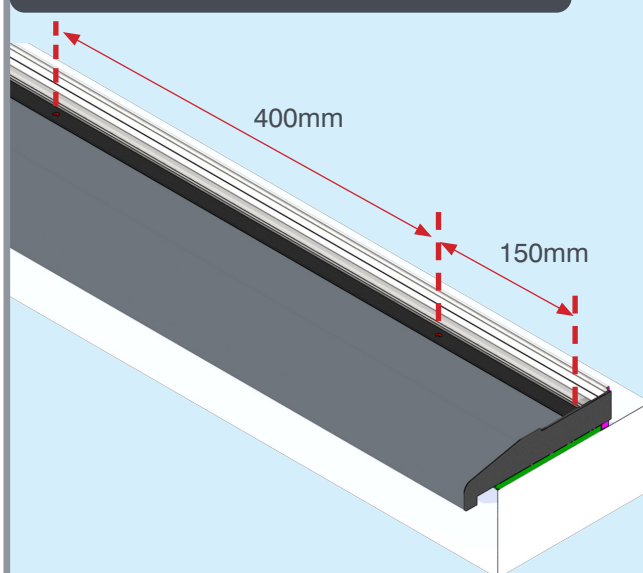

## 3 Fix down into position

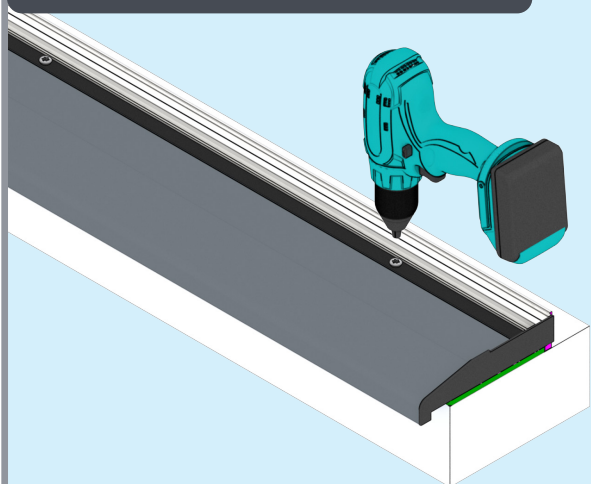

Ensure cill is packed level

## 4 Completed cill position showing packer

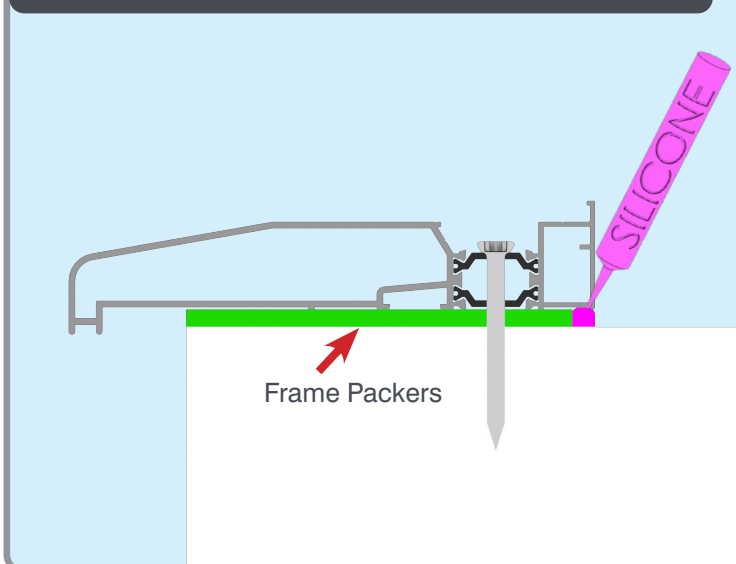

**Note - Cill packers and screws are not supplied**

**Ensure cill is level:  $\pm 2\text{mm}$**





# OUTERFRAME INSTALLATION

# 10



Not  
Supplied



Not  
Supplied



Not  
Supplied

## 1 Mounting outerframe

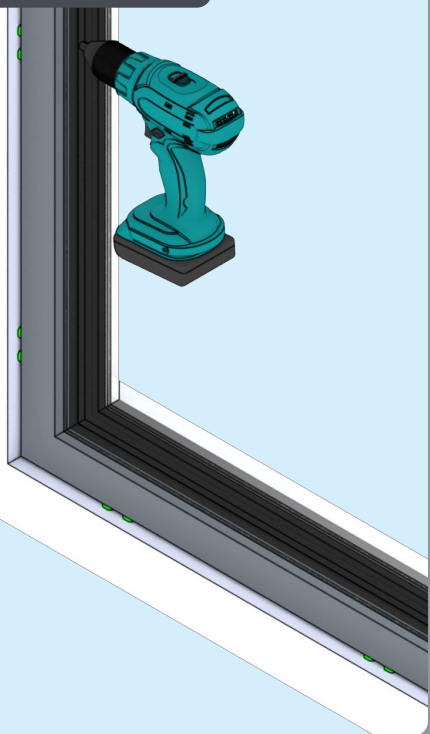

## 2 Drill and screw in position

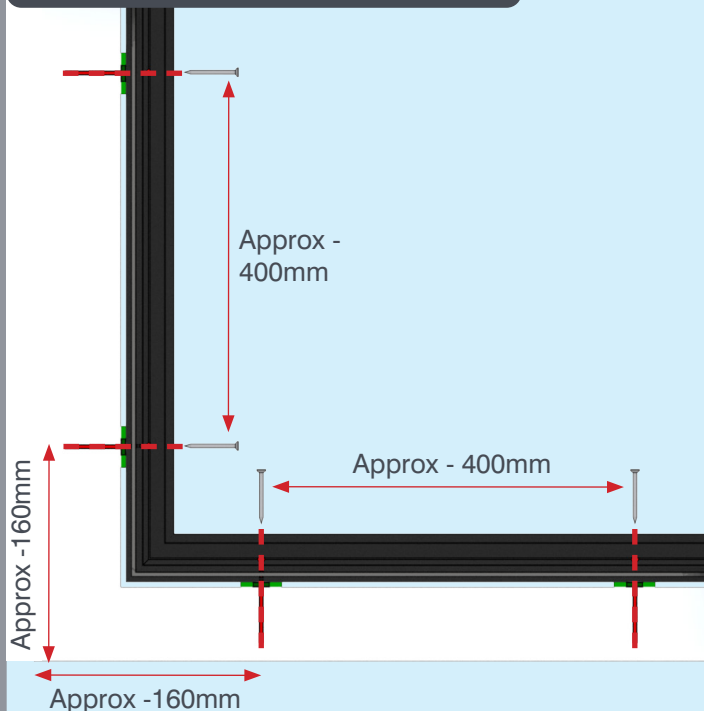

## 3 Outerframe fixing

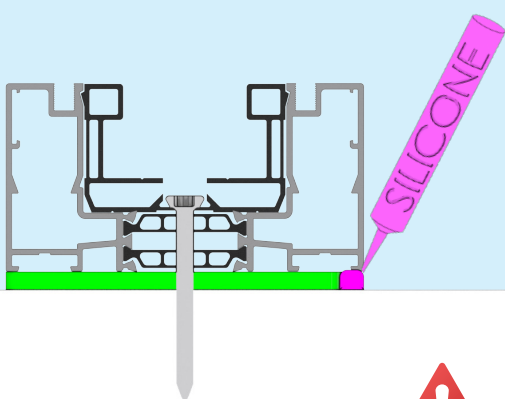

## 4 Outerframe fitted with optional cill fixing

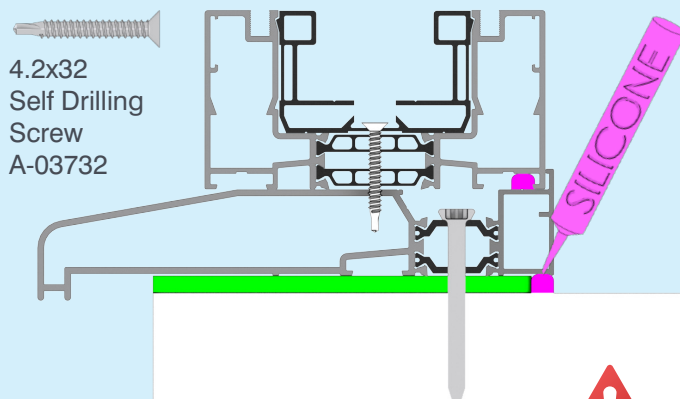

**Note - Frame packers and screws are not supplied**

**Ensure outerframe is plumb and square:  $\pm 2\text{mm}$**



# TRICKLE VENT INSTALLATION

11

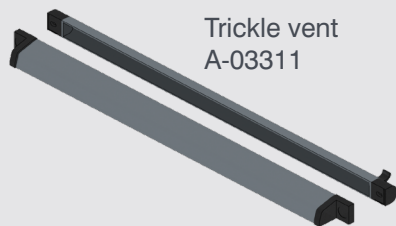

Trickle vent  
A-03311

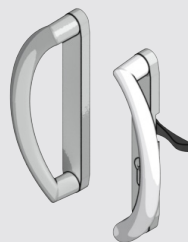

Chosen  
Handle Sets

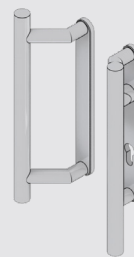

## 1 Trickle vent installation

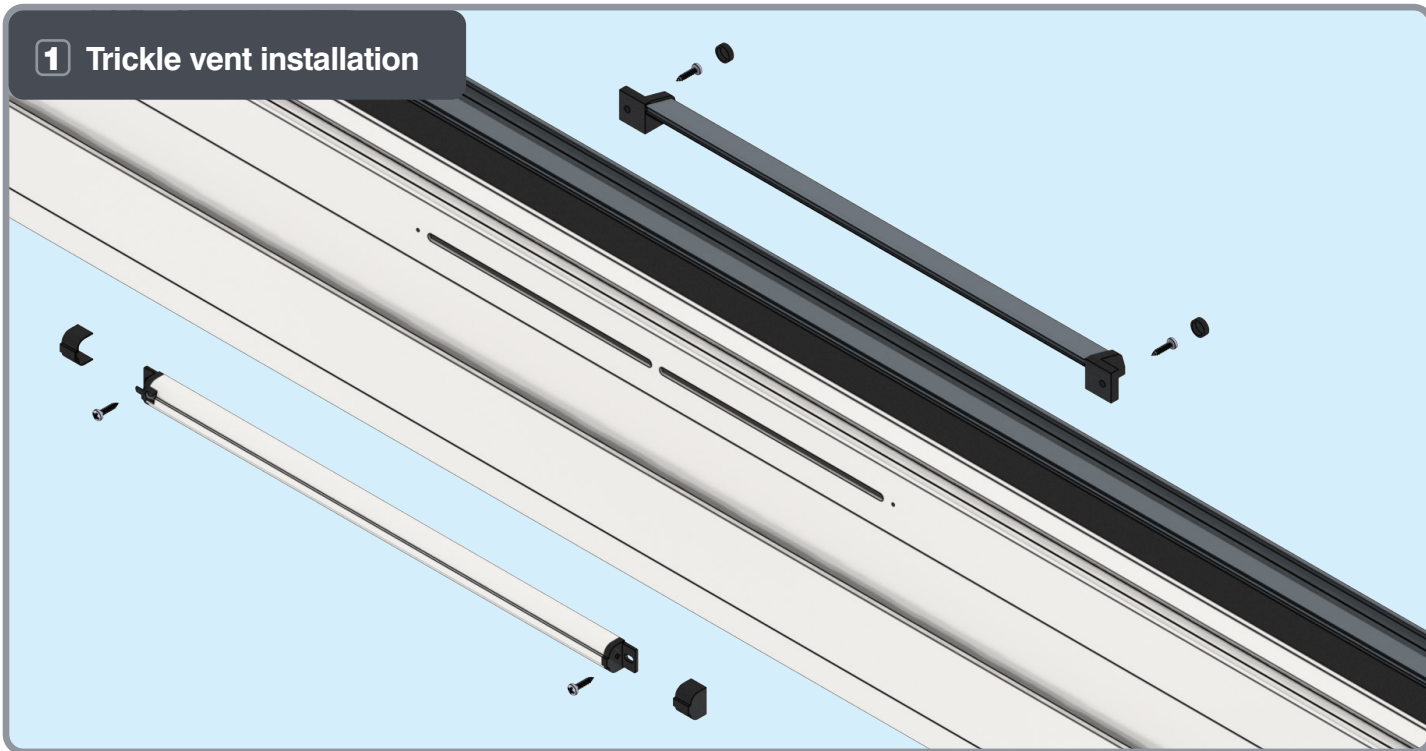

## 2 Type A handle

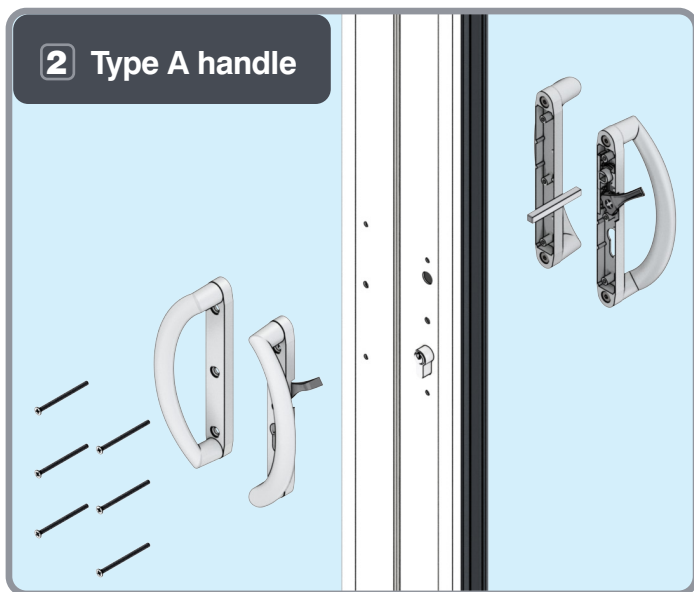

## 3 type B handle

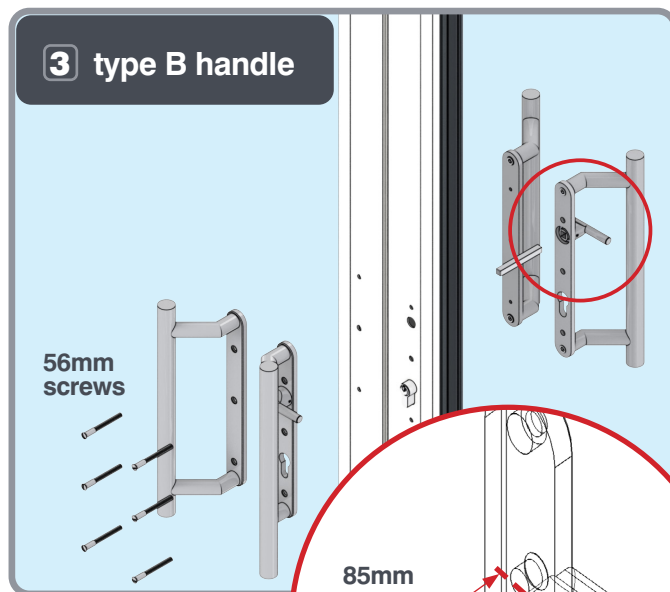

56mm  
screws

85mm  
length

68mm  
projection



**Ensure 85mm spindle stick-out is 68mm**  
**Ensure both grub screws are tight after fitting**

# FIXED SASH TRACK COVER INSTALLATION

12

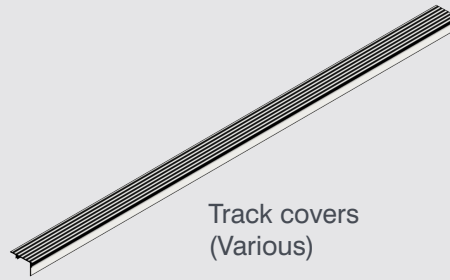

Track covers  
(Various)

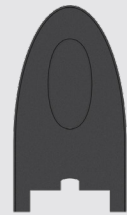

A-02705

## 1 Horizontal and vertical track covers

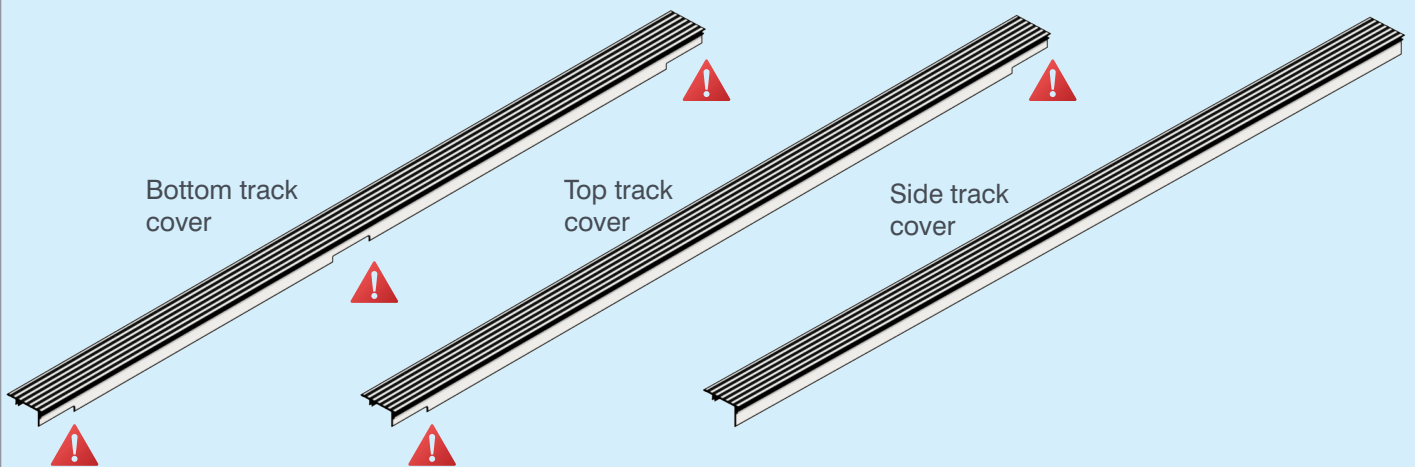

## 2 Top track covers

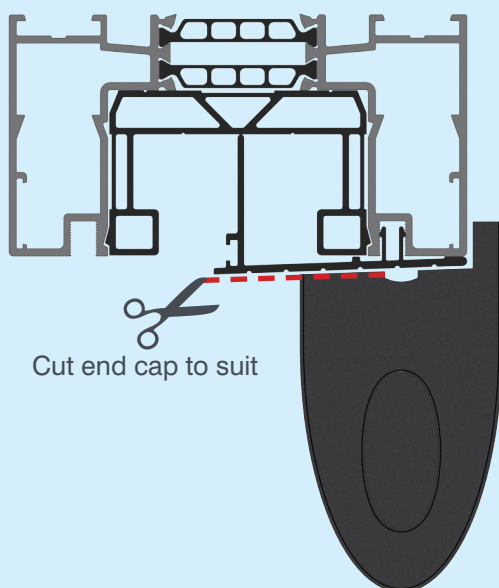

## 3 Bottom track covers

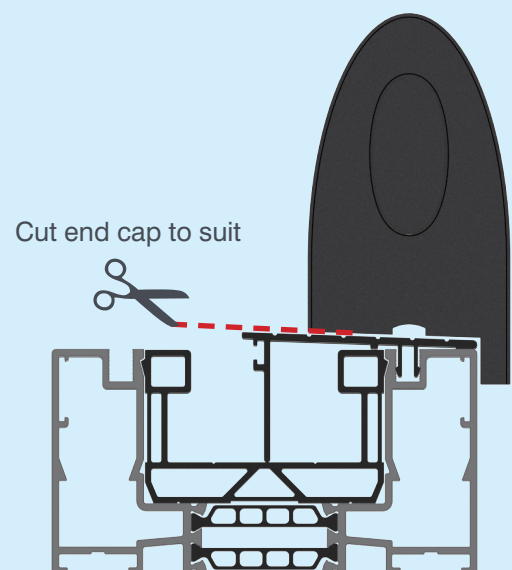

**Install bottoms, then tops, then sides.  
Ensure correct positioning, note cut outs**

## GLAZING

# 13



Wedge  
Gasket



Glazing packers  
A-03819: 1mm  
A-02886: 3mm

### 1 Glazing detail

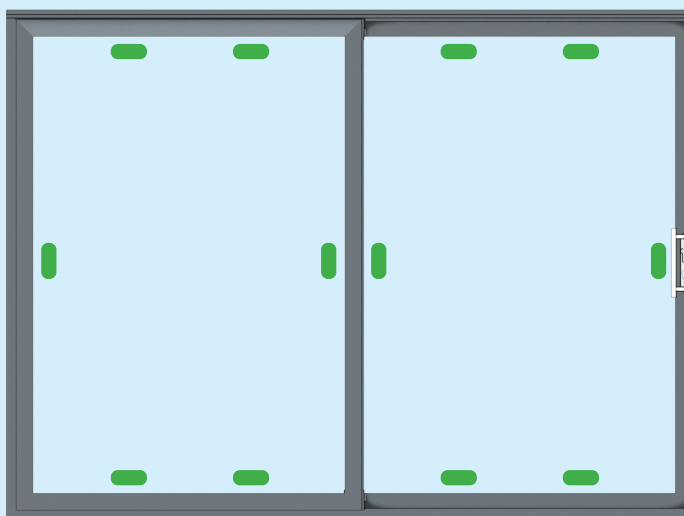
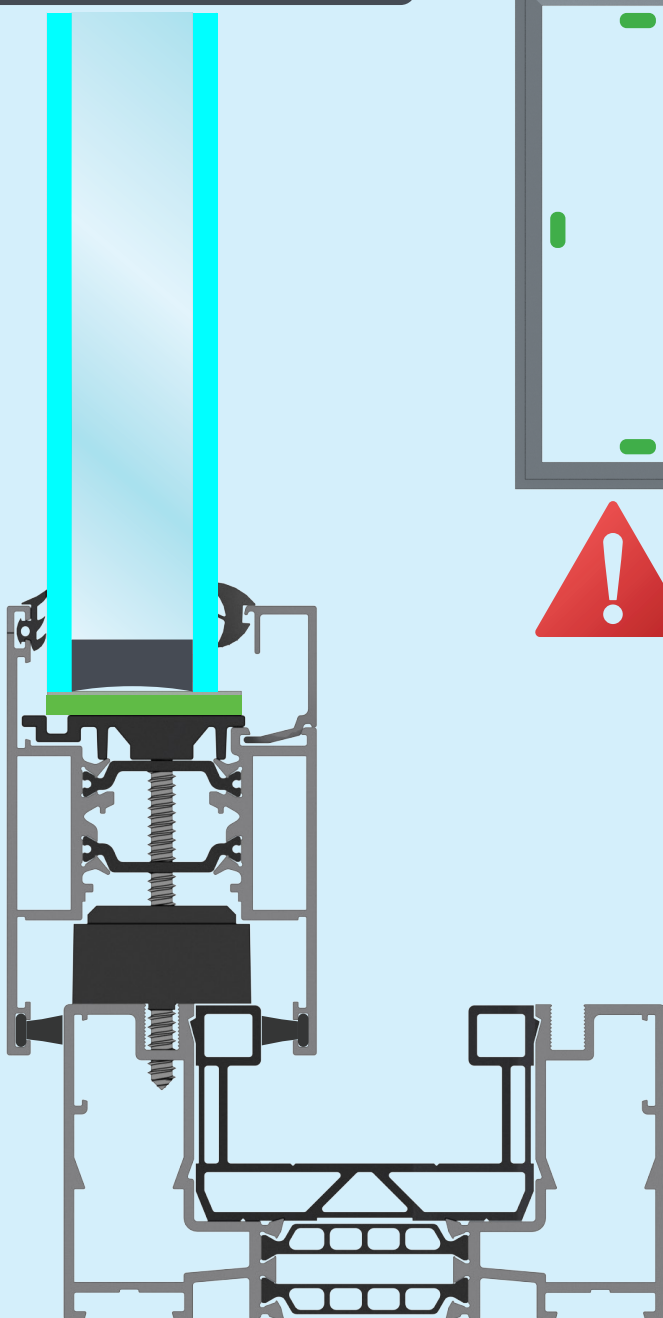

**Pack glass against  
installed bridge  
packers**



**After glazing and before final sealing, check door  
operation and adjust frame packers as required**





